

LICENSING ACT 2003



Bromsgrove
District Council
www.bromsgrove.gov.uk

PREMISES LICENCE

PREMISES LICENCE NUMBER

21/00981/PREMLI

Part 1 – Premises Details

Postal address of premises, or if none, ordnance survey map reference or description, including Post Town, Post Code

Coffee N Clay
5 Station Road
Hagley
Worcestershire
DY9 0NU

Where the licence is time limited, the dates
Not applicable

Licensable activities authorised by the licence and the times the licence authorises the carrying out of licensable activities

Activity – Sale of alcohol	Days	From	To	Consumption On/Off
Sale of Alcohol	Monday	12:00	- 17:00	On Premises
Sale of Alcohol	Tuesday	12:00	- 17:00	On Premises
Sale of Alcohol	Sunday	12:00	- 15:00	On Premises
Sale of Alcohol	Thursday - Saturday	12:00	- 22:00	On Premises

Activity - Other	Days	From	To	Indoors/Outdoors
-------------------------	-------------	-------------	-----------	-------------------------

Non-standard timings

None

The opening hours of the premises

Days	From	To
Monday	10:30	- 21:30
Tuesday	10:30	- 21:30
Sunday	11:00	- 16:00
Thursday - Saturday	10:30	- 21:30
None		

Where the licence authorises supplies of alcohol whether these are on and / or off supplies

Alcohol is supplied for consumption on the premises

Part 2

Name, (registered) address, telephone number and email (where relevant) of holder of premises licence

Miss Ruth Scattergood

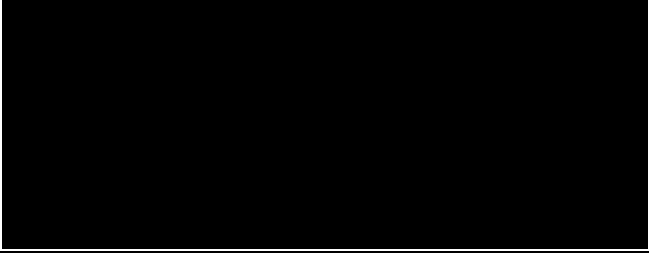

Registered number of holder, for example company number, charity number (where applicable)

Name, address and telephone number of designated premises supervisor where the premises licence authorises for the supply of alcohol

Ruth Scattergood



Personal licence number and issuing authority of personal licence held by designated premises supervisor where the premises licence authorises for the supply of alcohol

Personal Licence No: 21/02118/PERSLI

Licensing Authority: Wyre Forest District Council

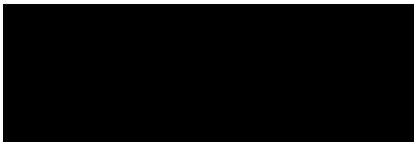

AUTHORISED OFFICER
Head of Regulatory Services
Worcestershire Regulatory Services
On behalf of Bromsgrove District Council

Date of first issue: 4 August 2021

This version valid from: 4 August 2021

Issuing Authority: Bromsgrove District Council
Parkside
Market Street
Bromsgrove
Worcestershire
B61 8DA

ANNEX 1 – MANDATORY CONDITIONS

The making and authorisation of alcohol sales

No supply of alcohol may be made under the premises licence—

- a) at a time when there is no designated premises supervisor in respect of the premises licence, or
- b) at a time when the designated premises supervisor does not hold a personal licence or his personal licence is suspended.

Every supply of alcohol under the premises licence must be made or authorised by a person who holds a personal licence.

Irresponsible alcohol promotions

The responsible person must ensure that staff on relevant premises do not carry out, arrange or participate in any irresponsible promotions in relation to the premises.

In this paragraph, an irresponsible promotion means any one or more of the following activities, or substantially similar activities, carried on for the purpose of encouraging the sale or supply of alcohol for consumption on the premises—

- (a) games or other activities which require or encourage, or are designed to require or encourage, individuals to—
 - (i) drink a quantity of alcohol within a time limit (other than to drink alcohol sold or supplied on the premises before the cessation of the period in which the responsible person is authorised to sell or supply alcohol), or
 - (ii) drink as much alcohol as possible (whether within a time limit or otherwise);
- (b) provision of unlimited or unspecified quantities of alcohol free or for a fixed or discounted fee to the public or to a group defined by a particular characteristic in a manner which carries a significant risk of undermining a licensing objective;
- (c) provision of free or discounted alcohol or any other thing as a prize to encourage or reward the purchase and consumption of alcohol over a period of 24 hours or less in a manner which carries a significant risk of undermining a licensing objective;
- (d) selling or supplying alcohol in association with promotional posters or flyers on, or in the vicinity of, the premises which can reasonably be considered to condone, encourage or glamorise anti-social behaviour or to refer to the effects of drunkenness in any favourable manner;
- (e) dispensing alcohol directly by one person into the mouth of another (other than where that other person is unable to drink without assistance by reason of disability).

Provision of free potable water

The responsible person must ensure that free potable water is provided on request to customers where it is reasonably available.

Age verification policy for the sale or supply of alcohol

The premises licence holder or club premises certificate holder must ensure that an age verification policy is adopted in respect of the premises in relation to the sale or supply of alcohol.

The designated premises supervisor in relation to the premises licence must ensure that the supply of alcohol at the premises is carried on in accordance with the age verification policy.

The policy must require individuals who appear to the responsible person to be under 18 years of age (or such older age as may be specified in the policy) to produce on request, before being served alcohol, identification bearing their photograph, date of birth and either—

- (a) a holographic mark, or
- (b) an ultraviolet feature.

Availability of small measures of alcohol

The responsible person must ensure that—

- (a) where any of the following alcoholic drinks is sold or supplied for consumption on the premises (other than alcoholic drinks sold or supplied having been made up in advance ready for sale or supply in a securely closed container) it is available to customers in the following measures—
 - (i) beer or cider: ½ pint;
 - (ii) gin, rum, vodka or whisky: 25 ml or 35 ml; and
 - (iii) still wine in a glass: 125 ml;
- (b) these measures are displayed in a menu, price list or other printed material which is available to customers on the premises; and

- (c) where a customer does not in relation to a sale of alcohol specify the quantity of alcohol to be sold, the customer is made aware that these measures are available.

Permitted price of alcohol

1. A relevant person shall ensure that no alcohol is sold or supplied for consumption on or off the premises for a price which is less than the permitted price
2. For the purposes of the condition set out in paragraph 1—
 - a) “duty” is to be construed in accordance with the Alcoholic Liquor Duties Act 1979);
 - b) “permitted price” is the price found by applying the formula—
$$P=D+(D\times V)$$
where—
 - P is the permitted price,
 - D is the rate of duty chargeable in relation to the alcohol as if the duty were charged on the date of the sale or supply of the alcohol, and
 - V is the rate of value added tax chargeable in relation to the alcohol as if the value added tax were charged on the date of the sale or supply of the alcohol;
 - c) “relevant person” means, in relation to premises in respect of which there is in force a premises licence—
 - (i) the holder of the premises licence,
 - (ii) the designated premises supervisor (if any) in respect of such a licence, or
 - (iii) the personal licence holder who makes or authorises a supply of alcohol under such a licence;
 - d) “relevant person” means, in relation to premises in respect of which there is in force a club premises certificate, any member or officer of the club present on the premises in a capacity which enables the member or officer to prevent the supply in question; and
 - e) “valued added tax” means value added tax charged in accordance with the Value Added Tax Act 1994.
3. Where the permitted price given by Paragraph (b) of paragraph 2 would (apart from this paragraph) not be a whole number of pennies, the price given by that sub-paragraph shall be taken to be the price actually given by that sub-paragraph rounded up to the nearest penny.
4.
 - (1) Sub-paragraph (2) applies where the permitted price given by Paragraph (b) of paragraph 2 on a day (“the first day”) would be different from the permitted price on the next day (“the second day”) as a result of a change to the rate of duty or value added tax.
 - (2) The permitted price which would apply on the first day applies to sales or supplies of alcohol which take place before the expiry of the period of 14 days beginning on the second day.

ANNEX 2 – CONDITIONS CONSISTENT WITH THE OPERATING SCHEDULE

a) General – all four licensing objectives (b,c,d,e):

b) The prevention of crime and disorder:

CCTV will be in operation in the shop so the licence holder can view and monitor. CCTV will cover the back garden and the front of the shop.

Customers will not be permitted to take any alcohol off the premises. The licence holder will ensure staff are vigilant when customers have finished their drinks by clearing glasses away from the tables.

A table booking policy is in place and this will remain in place. The licence holder will set a minimum amount of people allowed to book and all bookings are confirmed by the manager before confirmation is sent to the customer.

The licence holder will ensure that they have a proof of age policy in place.

The licence holder will ensure that the food is available at all times when the premises is open.

c) Public safety:

Fire Safety

The licence holder will comply with all fire safety standards and we have a robust fire safety policy in place.

All exit doors are easily opened without keys, security cards etc.

All fire doors are maintained unobstructed and effectively self-closing and will not be held open other than with approved devices.

All fire doors are maintained unobstructed and effectively self-closing and will not be held open other than with approved devices.

Adequate arrangements exist to enable the safe movement within the premises of disabled people and their safe evacuation in the event of an emergency.

First Aid

Adequate and appropriate First Aid equipment and materials are available on the premises.

Lighting

In the absence of adequate daylight suitable and sufficient artificial lighting is provided and maintained in any area accessible to the public.

Fire safety signs are adequately illuminated.

Emergency lighting is installed and regularly maintained.

Emergency lighting tests are conducted monthly. Records of these tests are available upon request.

The premises have current and suitable Public Liability Insurance. A certificate will be obtained each year and displayed at the premises.

The premises have current certificates of inspection for all portable fire fighting equipment. An inspection is carried out every 1 year and new certificates will be obtained at these intervals.

Free Drinking water is available at all times.

The licence holder operates a complete no smoking policy at the premises.

The licensable area provides seats for all customers

d) The prevention of public nuisance:

Noise or vibration from the premises will be maintained at a level that will not be audible at the facade of any neighbouring noise sensitive premises.

Prominent, clear and legible notices will be displayed at all exits requesting patrons to respect the needs of local residents and to leave the premises and the area quietly.

Disposal of empty bottles into waste receptacles outside the premises will not be permitted to take place between the hours of 2300 hrs and 0700 hrs to minimise disturbance to nearby occupiers

e) The protection of children from harm:

The licence holder will ensure staff enforce the proof of age policy

The hours of the day during which age restrictions apply are between 2100 hrs and 2200hrs.

Other operating conditions

ANNEX 3 – CONDITIONS ATTACHED AFTER A HEARING BY THE LICENSING AUTHORITY

ANNEX 4 – PLANS

As deposited with the licensing authority



PREMISES LICENCE SUMMARY

PREMISES LICENCE NUMBER

21/00981/PREMLI

Premises Details

Postal address of premises, or if none, ordnance survey map reference or description, including Post Town, Post Code

Coffee N Clay
5 Station Road
Hagley
Worcestershire
DY9 0NU

Where the licence is time limited the dates

Not applicable

Licensable activities authorised by the licence and the times the licence authorises the carrying out of licensable activities

Activity – Sale of alcohol	Days	From	To	Consumption On/Off
Sale of Alcohol	Monday	12:00	- 17:00	On Premises
Sale of Alcohol	Tuesday	12:00	- 17:00	On Premises
Sale of Alcohol	Sunday	12:00	- 15:00	On Premises
Sale of Alcohol	Thursday - Saturday	12:00	- 22:00	On Premises

Activity - Other	Days	From	To	Indoors/Outdoors
Non-standard timings				
None				

The opening hours of the premises

Days	From	To
Monday	10:30	- 21:30
Tuesday	10:30	- 21:30
Sunday	11:00	- 16:00
Thursday - Saturday	10:30	- 21:30
None		

Where the licence authorises supplies of alcohol whether these are on and / or off supplies

Alcohol is supplied for consumption on the premises

Name, (registered) address of holder of premises licence

Miss Ruth Scattergood

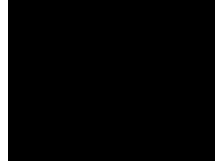

Registered number of holder, for example company number, charity number (where applicable)

Name of designated premises supervisor where the premises licence authorises for the supply of alcohol

Ruth Scattergood

State whether access to the premises by children is restricted or prohibited

No specific restrictions

Date of first issue: 4 August 2021

This version valid from: 4 August 2021

Issuing Authority: Bromsgrove District Council
Parkside
Market Street
Bromsgrove
Worcestershire
B61 8DA

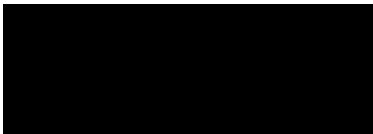

AUTHORISED OFFICER
Head of Regulatory Services
Worcestershire Regulatory Services
On behalf of Bromsgrove District Council

Coffee n Clay – Premises Plan V1

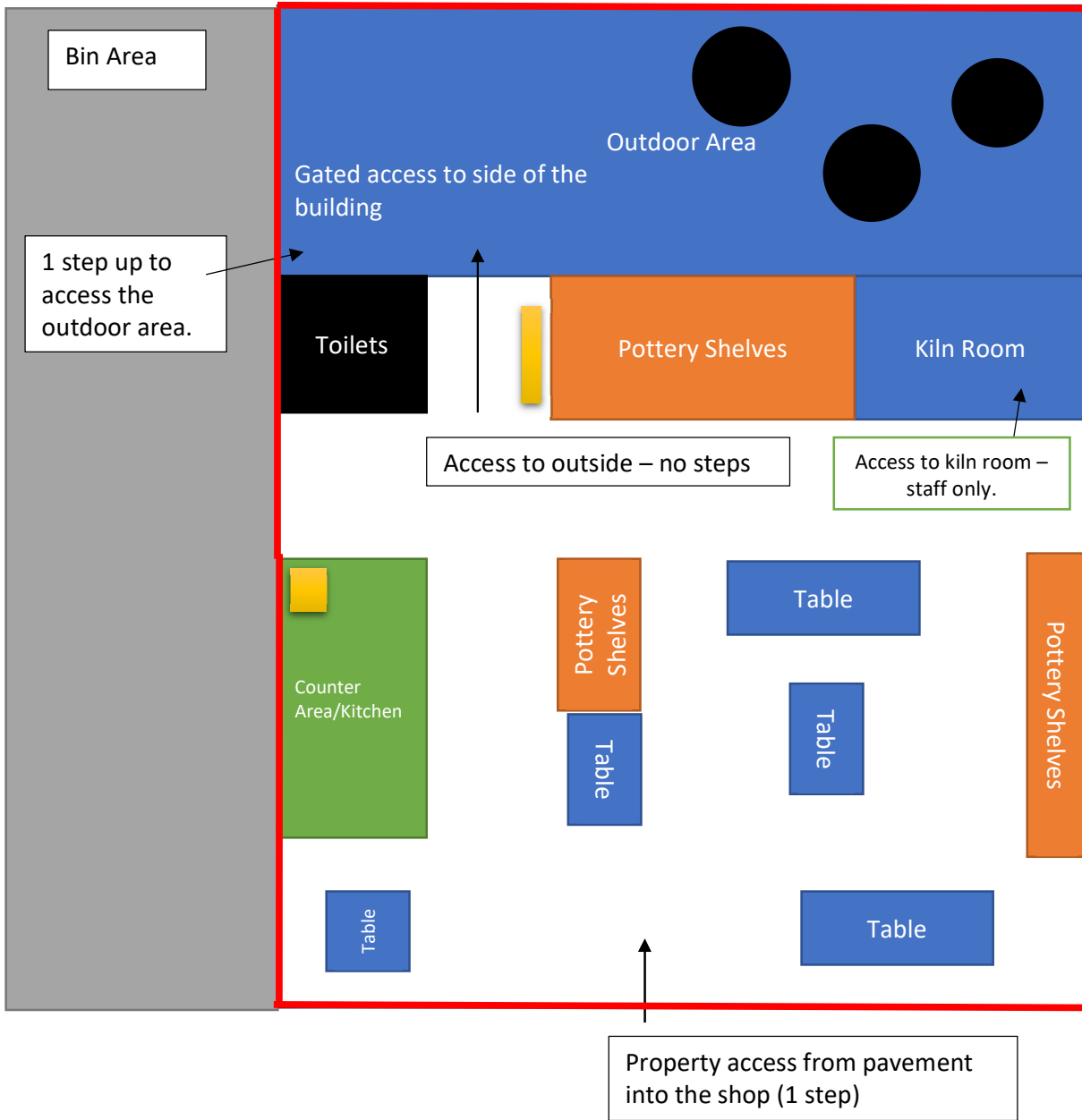

Fire Safety Equipment

— Licensable Area